

# Products For The Difficult Airway

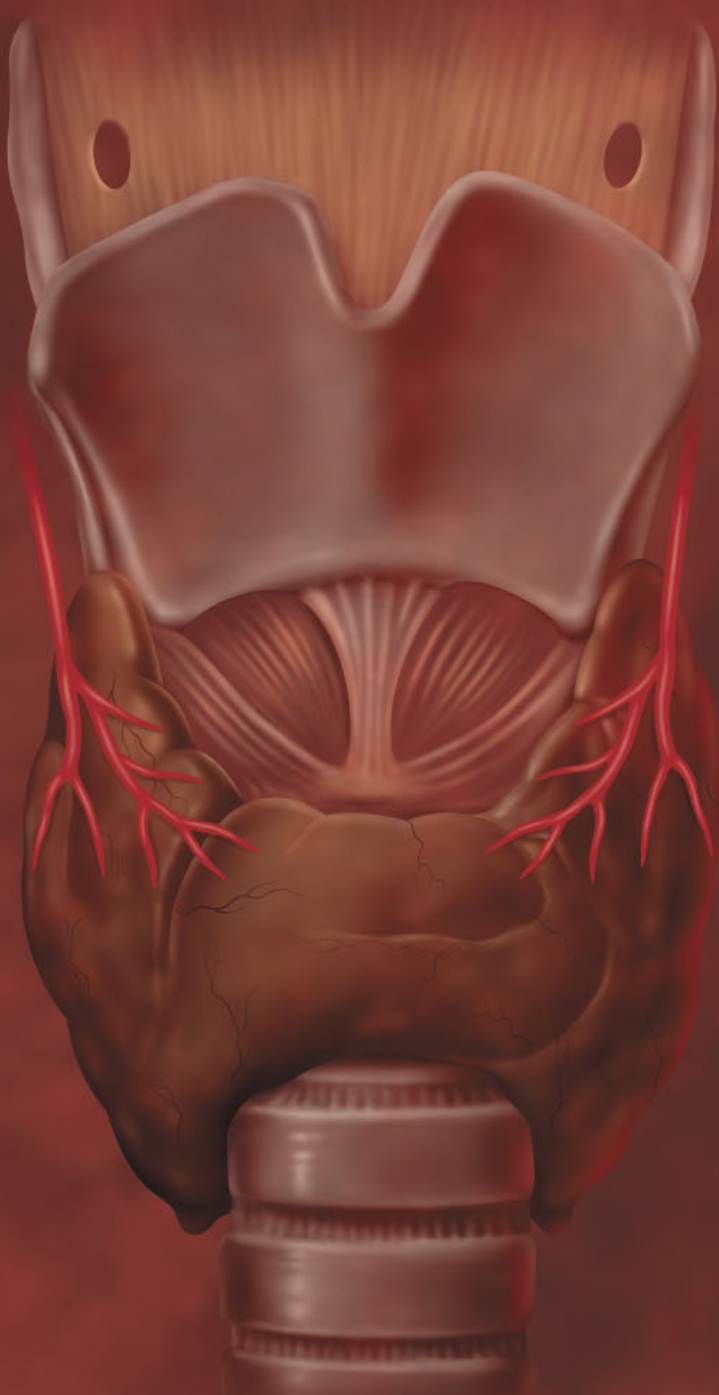

COOK®

## DIFFICULT AIRWAY ALGORITHM

1. Assess the likelihood and clinical impact of basic management problems:
  - A. Difficult Ventilation
  - B. Difficult Intubation
  - C. Difficulty with Patient Cooperation or Consent
  - D. Difficult Tracheostomy
2. Actively pursue opportunities to deliver supplemental oxygen throughout the process of difficult airway management
3. Consider the relative merits and feasibility of basic management choices:

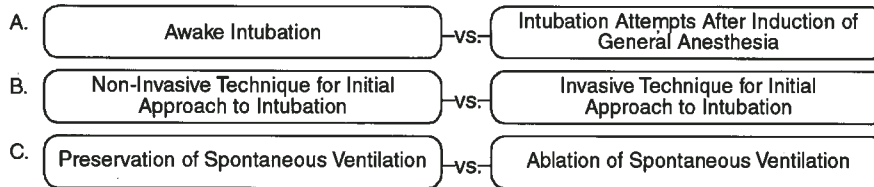

4. Develop primary and alternative strategies:

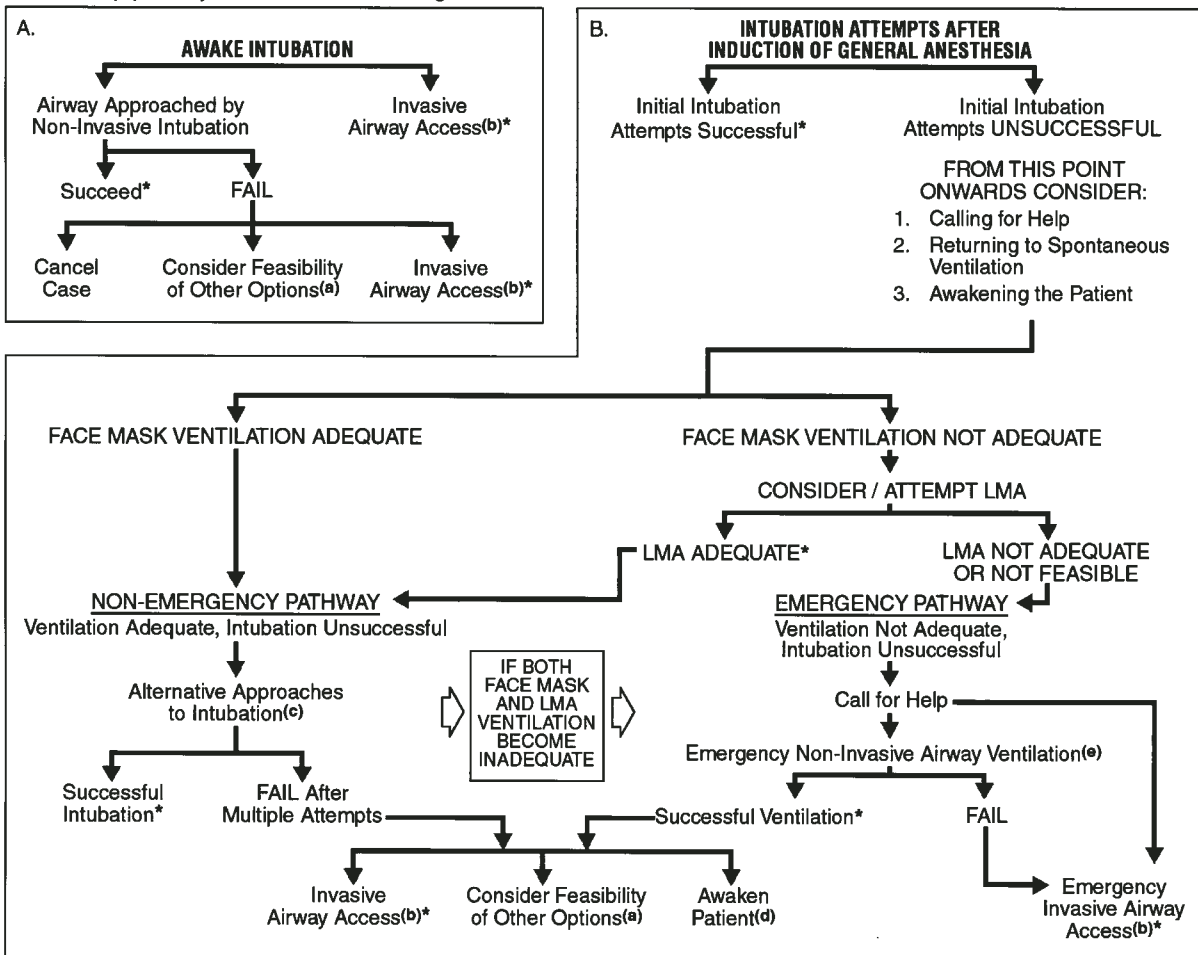

\* Confirm ventilation, tracheal intubation, or LMA placement with exhaled CO<sub>2</sub>

a. Other options include (but are not limited to): surgery utilizing face mask or LMA anesthesia, local anesthesia infiltration or regional nerve blockade. Pursuit of these options usually implies that mask ventilation will not be problematic. Therefore, these options may be of limited value if this step in the algorithm has been reached via the Emergency Pathway.

b. Invasive airway access includes surgical or percutaneous tracheostomy or cricothyrotomy.

c. Alternative non-invasive approaches to difficult intubation include (but are not limited to): use of different laryngoscope blades, LMA as an intubation conduit (with or without fiberoptic guidance), fiberoptic intubation, intubating stylet or tube changer, light wand, retrograde intubation, and blind oral or nasal intubation.

d. Consider re-preparation of the patient for awake intubation or canceling surgery.

e. Options for emergency non-invasive airway ventilation include (but are not limited to): rigid bronchoscope, esophageal-tracheal combitube ventilation, or transtracheal jet ventilation.

Fig. 1.

# Contents

<b>Melker Universal Emergency Cricothyrotomy Catheter Set</b> .....	4
<b>Melker Emergency Cricothyrotomy Catheter Sets – Cuffed</b> .....	5
<b>Melker Emergency Cricothyrotomy Catheter Sets</b> .....	6
<b>Melker Emergency Cricothyrotomy Catheter Set – Special Operations</b> .....	7
<b>Arndt Emergency Cricothyrotomy Catheter Set</b> .....	8
<b>Emergency Transtracheal Airway Catheters</b> .....	9
<b>Enk Oxygen Flow Modulator Sets</b> .....	10
<b>Wadhwa Emergency Airway Device</b> .....	11
<b>Cook Retrograde Intubation Sets with Rapi-Fit® Adapters</b> .....	12
<b>Cook Airway Exchange Catheters</b> .....	13
<b>Cook Airway Exchange Catheters EF – Extra Firm</b> .....	14
<b>Aintree Intubation Catheter</b> .....	15
<b>Frova Intubating Introducers</b> .....	16
<b>Enk Fiberoptic Atomizer Set</b> .....	17
<b>Management of the Difficult Airway CD-ROM</b> .....	18
<b>Fundamentals of Airway Management Techniques – A Color Atlas</b> .....	18
<b>Use of Rapi-Fit® Adapter</b> .....	19
<b>References</b> .....	19
<b>Acknowledgements</b> .....	19
<b>Videotapes</b> .....	19
<b>CD-Rom</b> .....	19
<b>Posters</b> .....	19
<b>Slides</b> .....	19

## MELKER UNIVERSAL EMERGENCY CRICOTHYROTOMY CATHETER SET

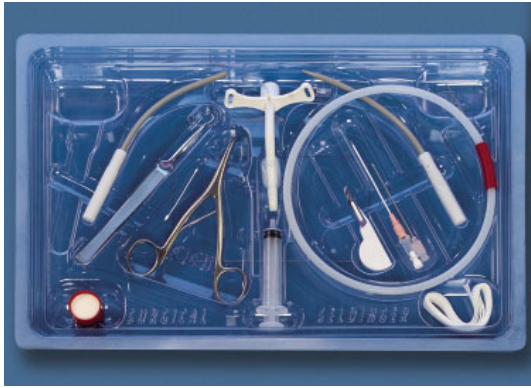

Used for emergency airway access when conventional endotracheal intubation cannot be performed.

- Airway access is achieved utilizing percutaneous entry (Seldinger) or surgical technique via the cricothyroid membrane.
- Supplied sterile in peel-open packages. Intended for one-time use.

### COMPONENTS USED FOR SELDINGER TECHNIQUE

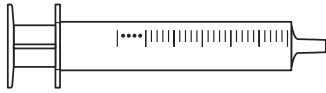

SYRINGE



INTRODUCER NEEDLE  
18 gage appropriate length

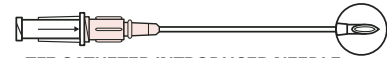

TFE CATHETER INTRODUCER NEEDLE  
18 gage appropriate length



AMPLATZ EXTRA STIFF WIRE GUIDE  
.038 inch diameter stainless steel, appropriate length with flexible tip



SCALPEL

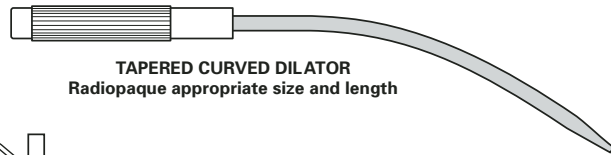

TAPERED CURVED DILATOR  
Radiopaque appropriate size and length

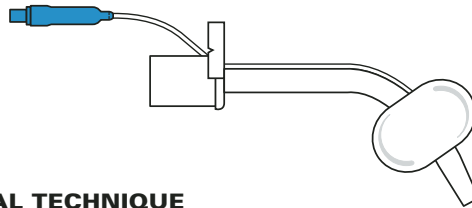

INFLATED AIRWAY CATHETER  
Polyvinylchloride

### COMPONENTS USED FOR SURGICAL TECHNIQUE

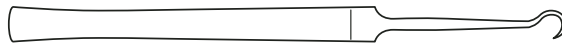

TRACHEAL HOOK

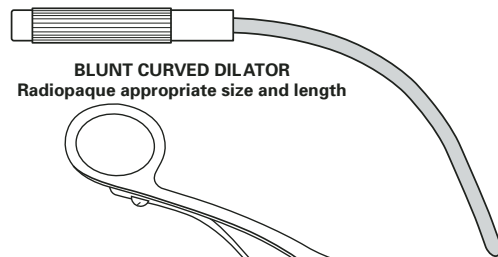

BLUNT CURVED DILATOR  
Radiopaque appropriate size and length



#11 SAFETY SCALPEL

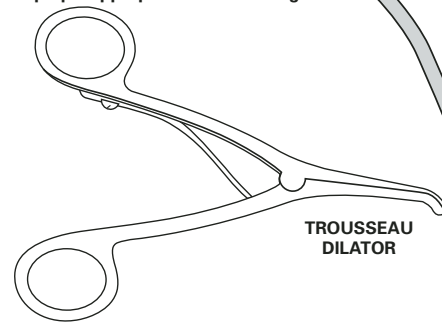

TROUSSEAU DILATOR

Set includes one airway catheter (shown) to be used with either blunt or tapered dilator.

SET  
ORDER  
NUMBER<sup>1</sup>

AIRWAY CATHETER

Global  
Product  
Number

C-TCCSB-500-UNI

Inner Diameter

Length

5 mm

9 cm

G32193

<sup>1</sup>Set consists of items shown above and drape, gauze pads, povidone-iodine swabsticks and solution, needle holder cup and cloth tracheostomy tape strip for fixation of airway catheter.

## MELKER EMERGENCY CRICOTHYROTOMY CATHETER SETS CUFFED

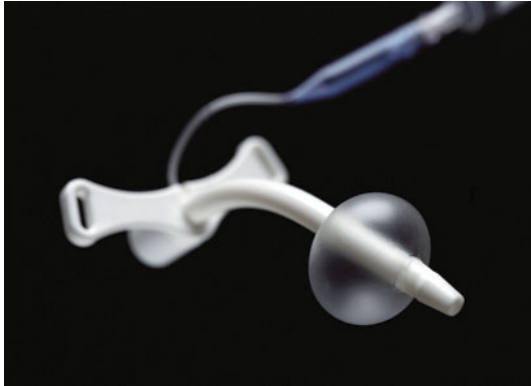

Used for emergency airway access when conventional endotracheal intubation cannot be performed.

- Airway access is achieved utilizing percutaneous entry (Seldinger) technique via the cricothyroid membrane.
- Subsequent dilation of the tract and tracheal entrance site permits passage of the emergency airway.
- Catheter is cuffed to protect and control airway.
- Airway catheter has radiopaque stripe.

Supplied sterile in peel-open packages. Intended for one-time use.

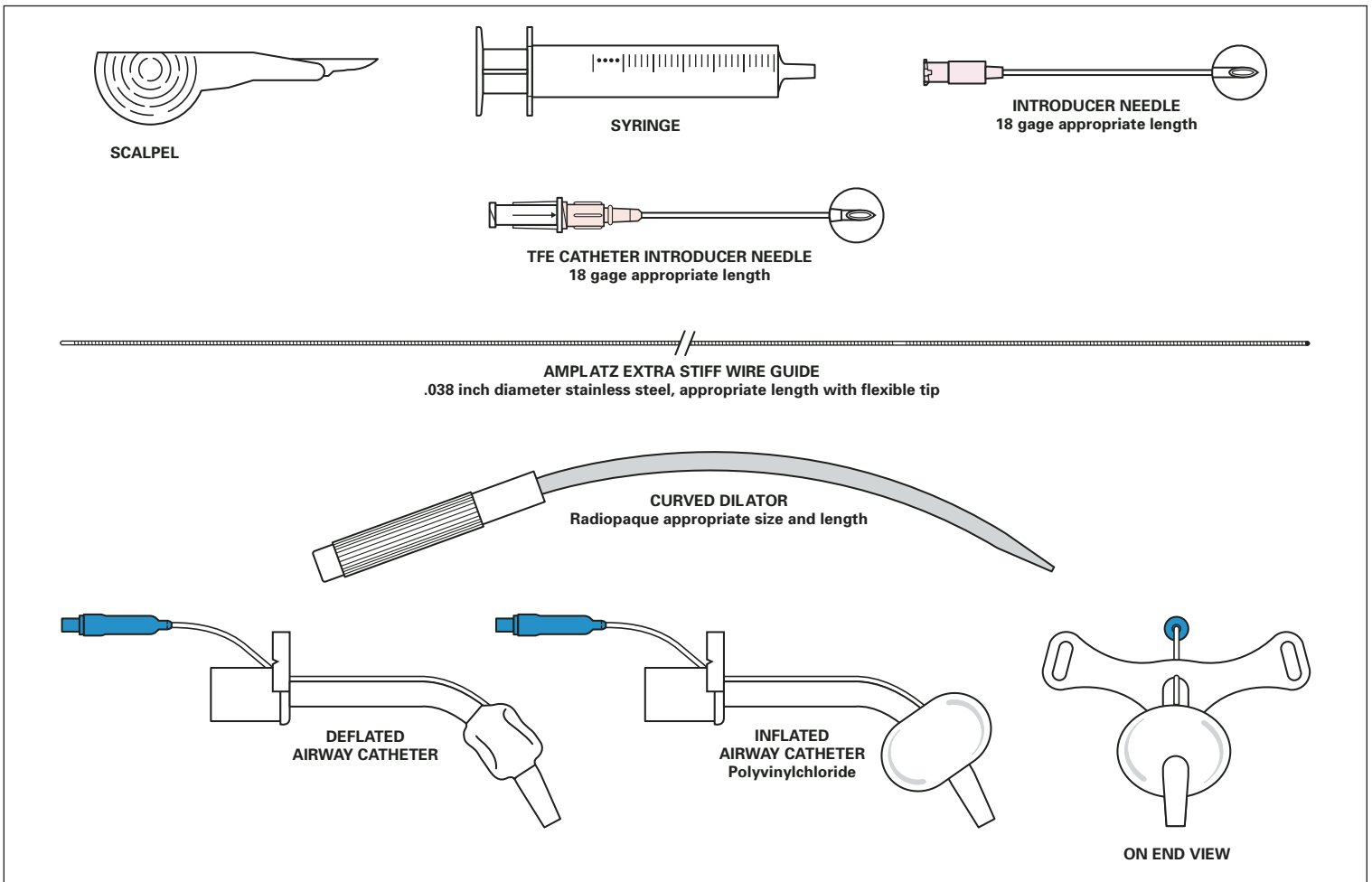

SET ORDER NUMBER <sup>1</sup>	AIRWAY CATHETER		Global Product Number	Remarks
	Inner Diameter	Length		
C-TCCSB-500	5 mm	9 cm	G29432	
C-TCCSB-500-SPOPS	5 mm	9 cm	G26924	Custom packaged in slip peel-pouch design for easy transportation. Dilator is pre-inserted into airway catheter. Includes two 18 gage introducer needles, 5 cm and 7 cm.

<sup>1</sup>Sets consist of items shown above and cloth tracheostomy tape strip for fixation of airway catheter.

## MELKER EMERGENCY CRICOTHYROTOMY CATHETER SETS

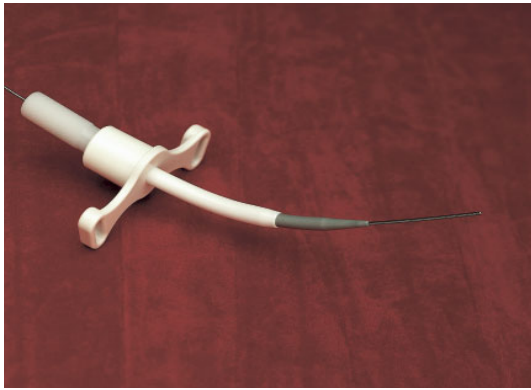

Used for emergency airway access when endotracheal intubation cannot be performed.

- Airway access is achieved utilizing percutaneous entry (Seldinger) technique via the cricothyroid membrane.
- Subsequent dilation of the tract and tracheal entrance site permits passage of the emergency airway.
- Airway catheter has radiopaque stripe.

Supplied sterile in peel-open packages. Intended for one-time use.

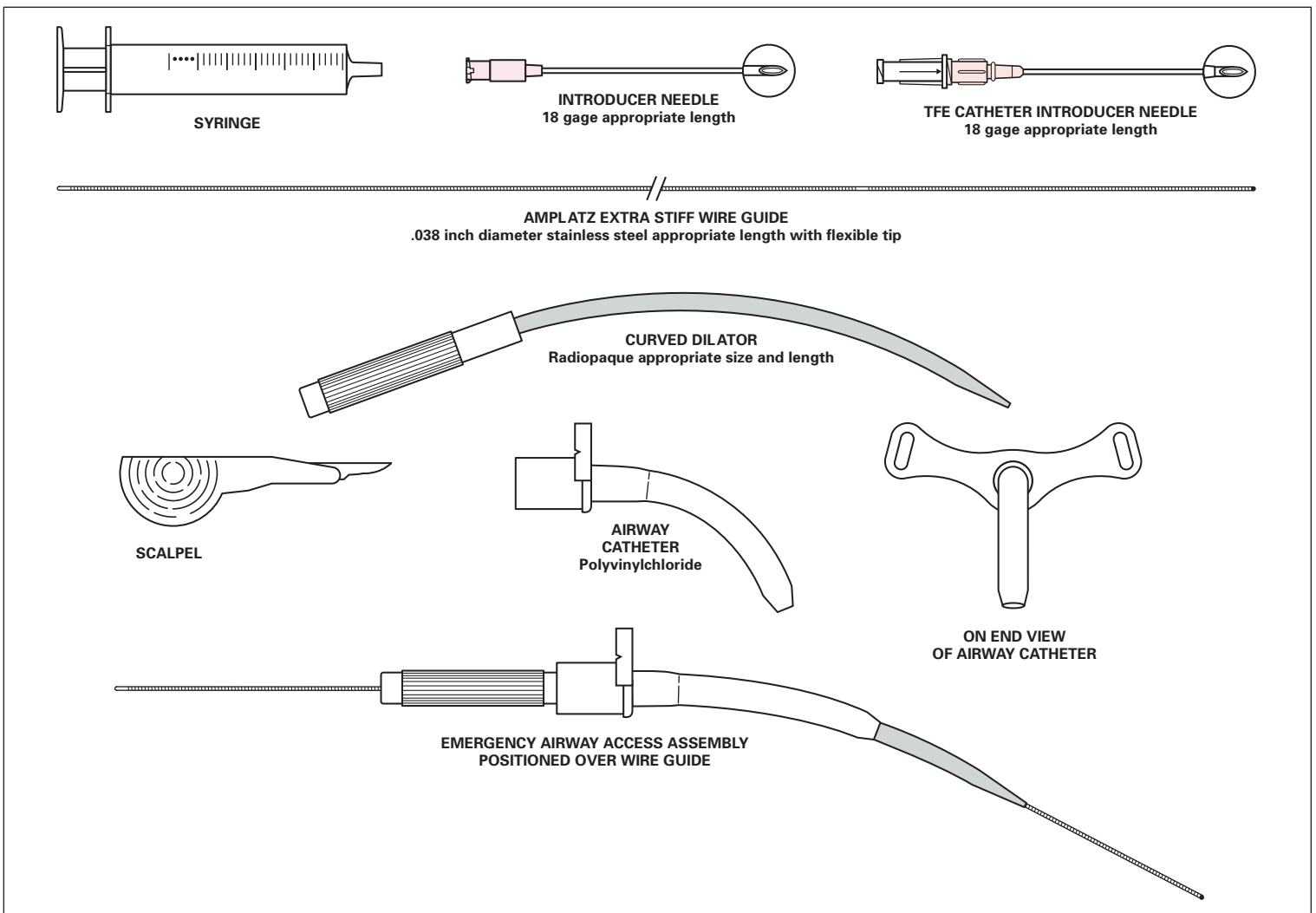

SET ORDER NUMBER <sup>1</sup>	AIRWAY CATHETER		Global Product Number
	Inner Diameter	Length	
C-TCCS-600	6 mm	7.5 cm	G04652
C-TCCS-400	4 mm	4.2 cm	G06246
C-TCCS-350	3.5 mm	3.8 cm	G06245

<sup>1</sup>Sets consist of items shown above and cloth tracheostomy tape strip for fixation of airway catheter.

# MELKER EMERGENCY CRICOTHYROTOMY CATHETER SET

## SPECIAL OPERATIONS

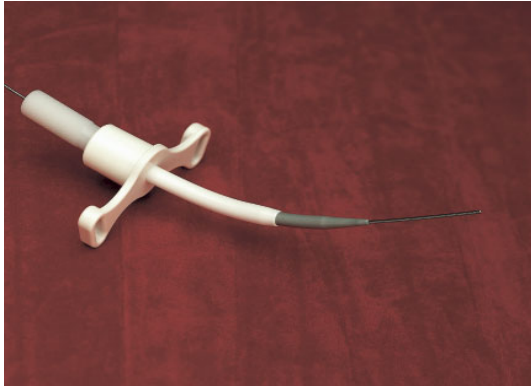

Used for emergency airway access when endotracheal intubation cannot be performed.

- Airway access is achieved utilizing percutaneous entry (Seldinger) technique via the cricothyroid membrane.
- Subsequent dilation of the tract and tracheal entrance site permits passage of the emergency airway.
- Airway catheter has radiopaque stripe.
- Custom packaged in slip peel-pouch design for easy transportation.
- Combines 4.0 mm catheter with a 6.0 mm catheter in one package thereby reducing the number of kits needed in the field.
- Dilators are pre-inserted into airway catheters.

Supplied sterile in peel-open packages. Intended for one-time use.

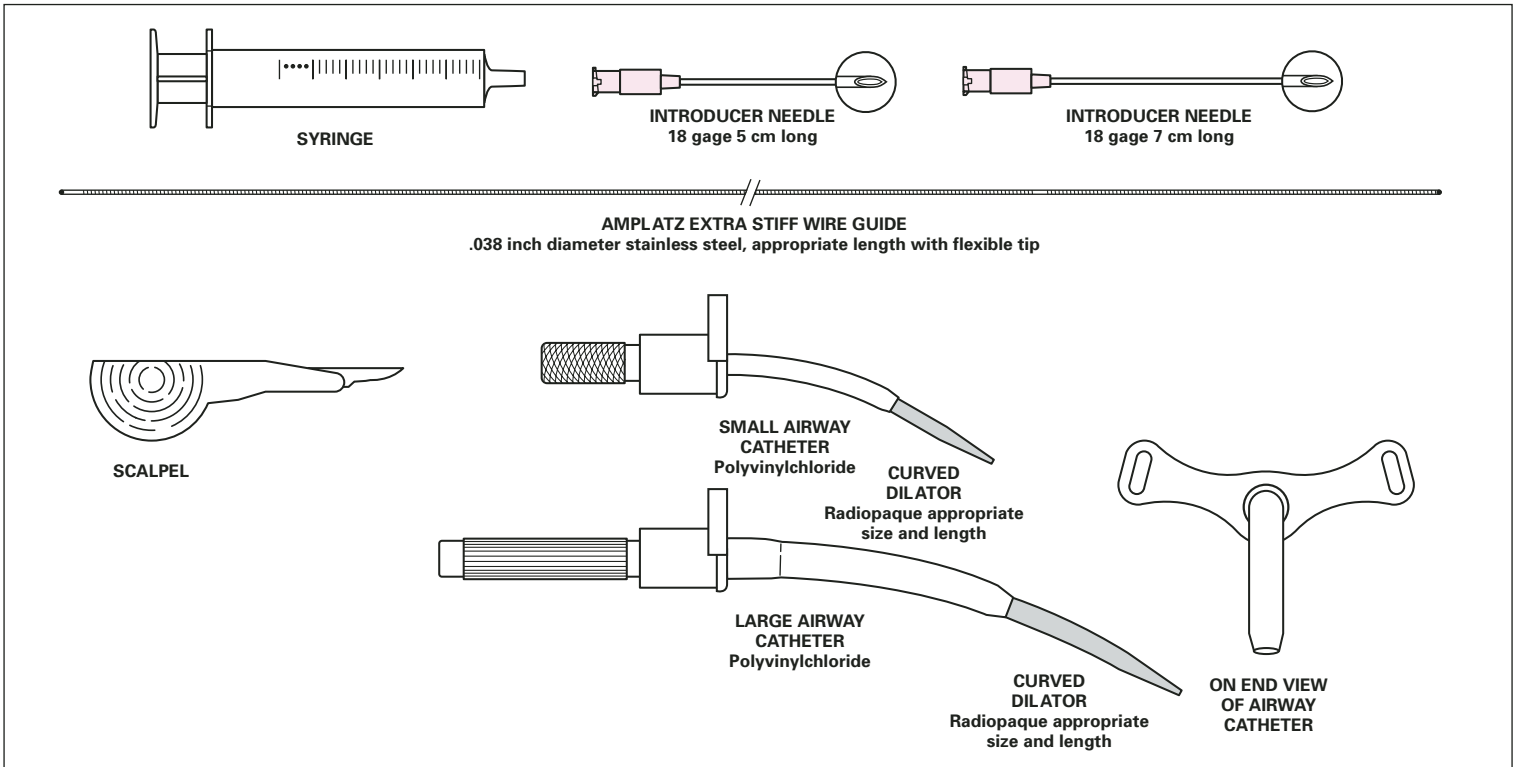

SET ORDER NUMBER <sup>1</sup>	SMALL AIRWAY CATHETER		LARGE AIRWAY CATHETER		Global Product Number
	Inner Diameter	Length	Inner Diameter	Length	
<b>C-TCCS-600-SPOPS</b>	4 mm	4.2 cm	6 mm	7.5 cm	<b>G10699</b>

<sup>1</sup>Set consists of items shown above and cloth tracheostomy tape strip for fixation of airway catheter.

Patent Number 4,677,978

## ARNDT EMERGENCY CRICOTHYROTOMY CATHETER SET

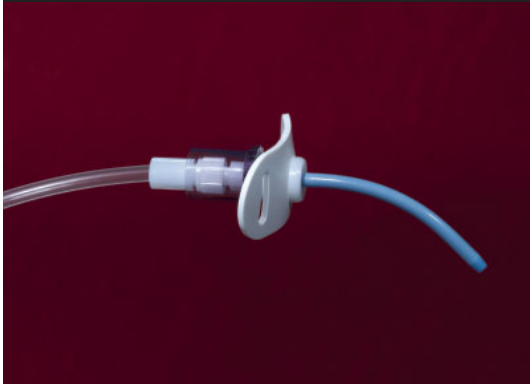

Used for emergency airway access when conventional endotracheal intubation and ventilation cannot be performed.

- Airway access is achieved utilizing percutaneous entry (Seldinger) technique via the cricothyroid membrane.
- Subsequent dilation of the tract and tracheal entrance site permits passage of the emergency airway.

Supplied sterile in peel-open packages. Intended for one-time use.

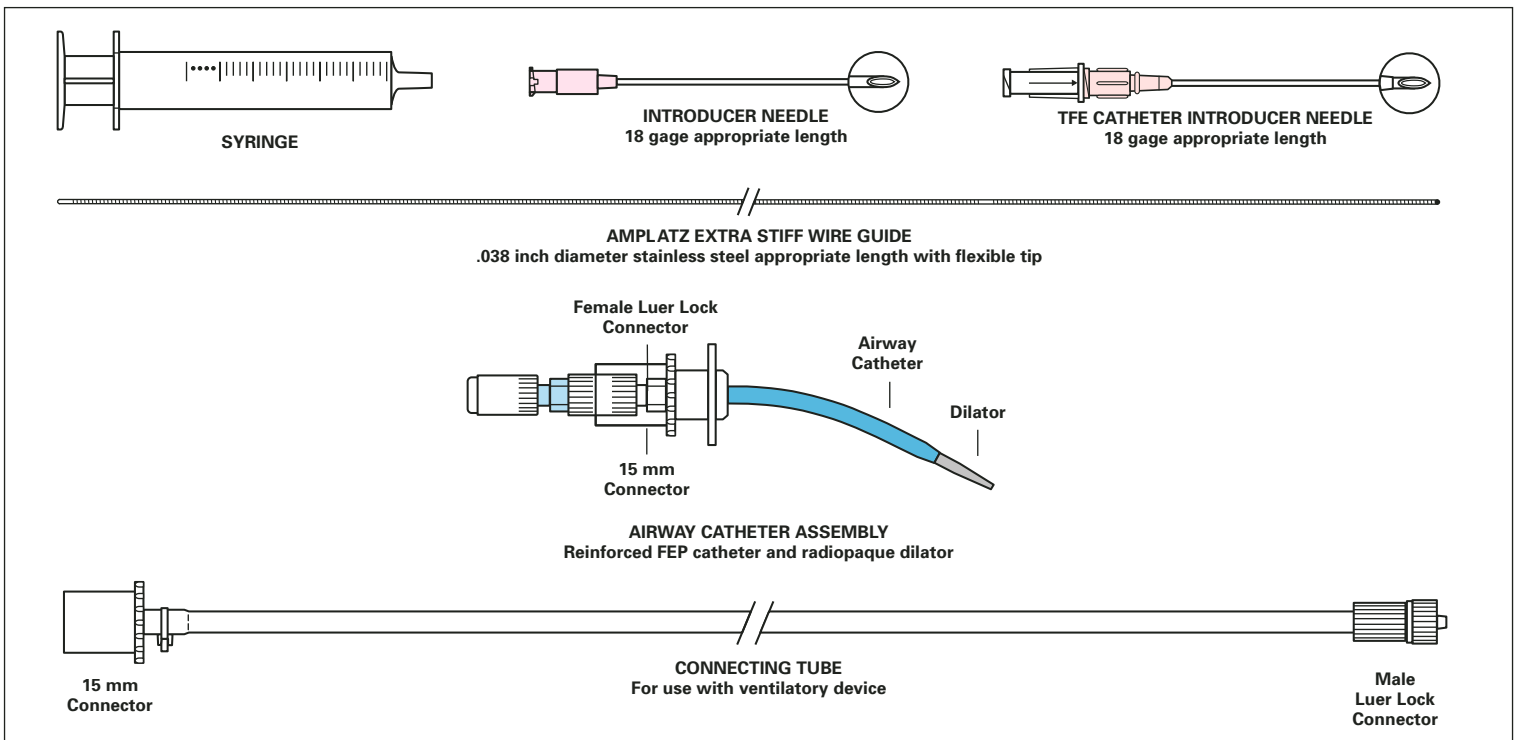

SET ORDER NUMBER <sup>1</sup>	AIRWAY CATHETER		NEEDLE	Global Product Number
	Inner Diameter	Length	Gage	
<b>C-DTJV-9.0-6.0-ARNDT</b>	3 mm	6 cm	18	<b>G08251</b>

<sup>1</sup>Set consists of items shown above, sterile water, scalpel and cloth tracheostomy tape strip for fixation of airway catheter.



## EMERGENCY TRANSTRACHEAL AIRWAY CATHETERS



Used for emergency airway access when conventional endotracheal intubation cannot be performed. Supplied sterile in peel-open packages. Intended for one-time use.

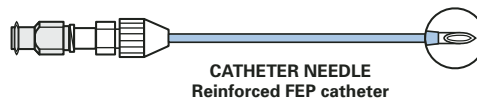

ORDER NUMBER	French Size	CATHETER		NEEDLE		Global Product Number
		Inner Diameter	Length	Gage		
<b>C-DTJV-6.0-5.0-BTT</b>	6.0	2 mm	5.0 cm	15		<b>G10338</b>
<b>C-DTJV-6.0-7.5-BTT</b>	6.0	2 mm	7.5 cm	15		<b>G09413</b>

## ENK OXYGEN FLOW MODULATOR SETS



Used with emergency transtracheal catheter ventilation when conventional ventilation by mask or endotracheal tube cannot be performed. The device allows manually controlled oxygen flow. **Please refer to product insert prior to use.** Supplied sterile in peel-open packages. Intended for one-time use.

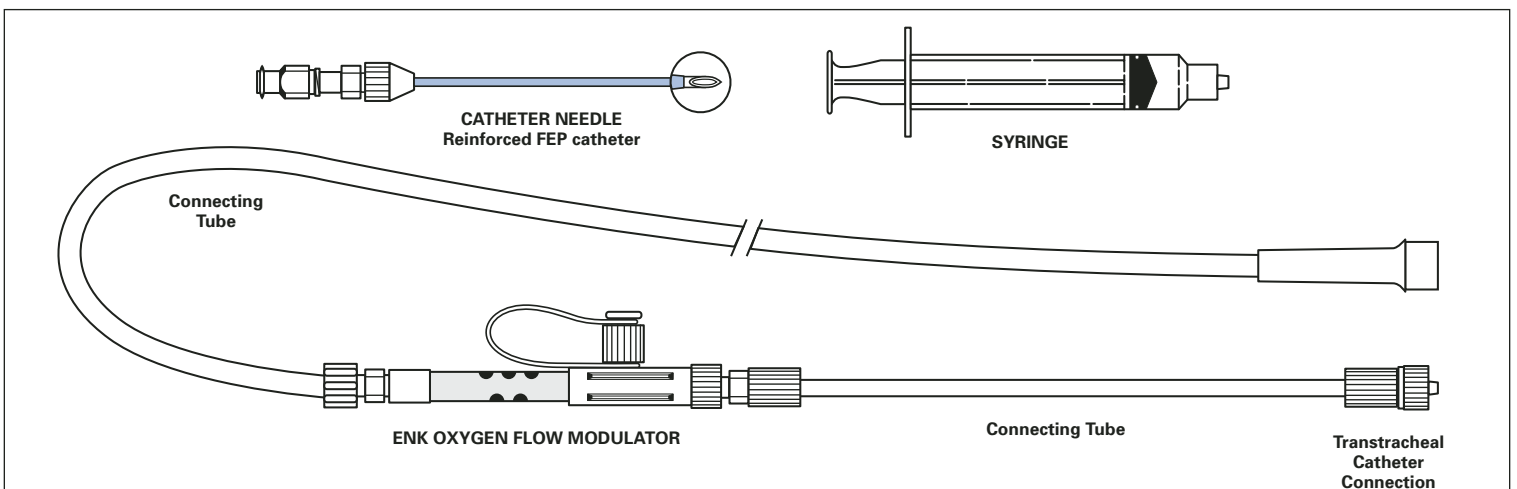

SET ORDER NUMBER	CATHETER			NEEDLE		Global Product Number
	French Size	Length	Inner Diameter	Gage	Remarks	
C-EFMS-100	6.0	7.5 cm	2 mm	15	SET includes items shown above.	G12398
C-EFMS-101	6.0	5.0 cm	2 mm	15	SET includes items shown above.	G13145

## WADHWA EMERGENCY AIRWAY DEVICE



Used for emergency airway access when conventional endotracheal intubation cannot be performed.

- Components of the set include nasopharyngeal airway catheter, cricothyrotomy catheter and 15 mm adapter.
- This device and all of its components require pre-assembly and once assembled are non-sterile.

Intended for one-time use.

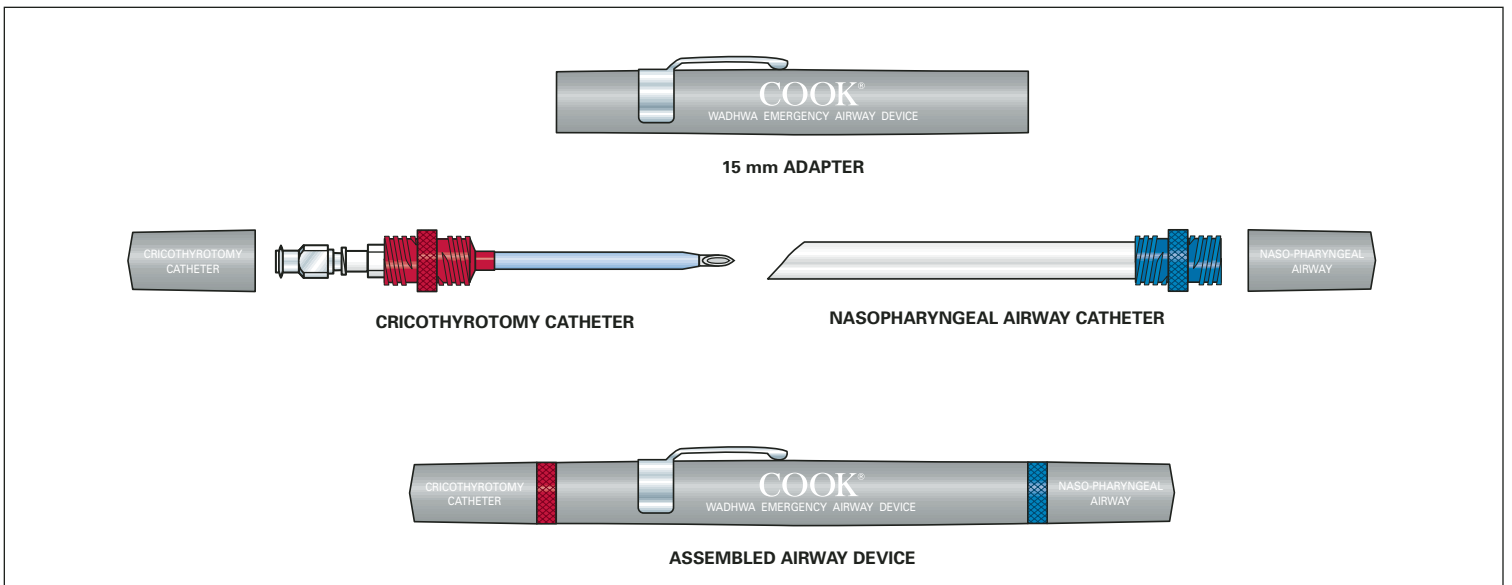

ORDER NUMBER	CRICOTHYROTOMY CATHETER		NASOPHARYNGEAL AIRWAY CATHETER		Global Product Number
	French Size	Length	Inner Diameter	Length	
<b>C-WEAD-100</b>	9.0	6 cm	7.0 mm	9.5 cm	<b>G26948</b>

Patent Number 4,893,620

## COOK RETROGRADE INTUBATION SETS WITH RAPI-FIT® ADAPTERS



Used to assist in the placement of an endotracheal tube during difficult airway access procedures.

- Initial access utilizing the Seldinger technique via the cricothyroid membrane permits retrograde (cephalad directed) placement of a wire guide exiting orally or nasally.
- Antegrade introduction of a hollow guiding catheter with distal side-ports and Rapi-Fit® Adapters allows patient oxygenation and facilitates placement of an endotracheal tube.

Supplied sterile in peel-open packages. Intended for one-time use.

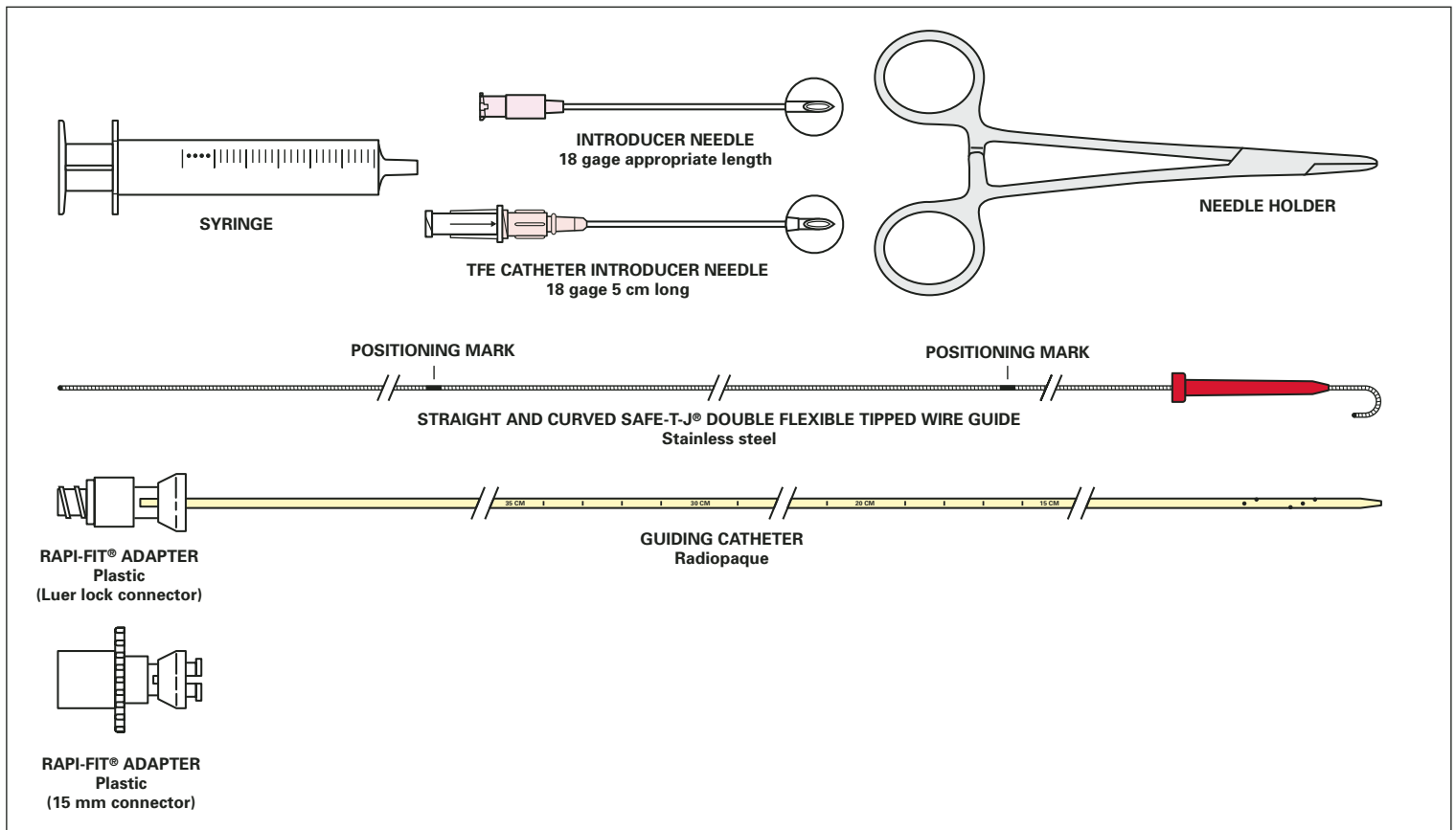

SET ORDER NUMBER	CATHETER		WIRE GUIDE			Use with Endotracheal Tube with Inner Diameter	Global Product Number
	French Size	Length	Diameter	Length	Tip		
C-RETRO-6.0-50-38J-110	6.0	50 cm	.038 inch	110 cm	straight and 3 mm "J"	2.5 mm or larger	G09727
C-RETRO-11.0-70-38J-110	11.0	70 cm	.038 inch	110 cm	straight and 3 mm "J"	4.0 mm or larger	G07647
C-RETRO-14.0-70-38J-110-CAE	14.0	70 cm	.038 inch	110 cm	straight and 3 mm "J"	5.0 mm or larger	G10554

### Replacement Wire Guide

C-DOC-38-110-0-3-RETRO			.038 inch	110 cm	straight and 3 mm "J"		G07622
------------------------	--	--	-----------	--------	-----------------------	--	--------

## COOK AIRWAY EXCHANGE CATHETERS



Used for uncomplicated, atraumatic endotracheal tube exchange.

- Use of removable Rapi-Fit® Adapter permits use of ventilatory device if necessary during exchange procedure.
- Through-lumen design of catheter with distal sideports ensures adequate air flow.
- Blunt tip of catheter is atraumatic to internal structures.
- Centimeter marks facilitate accurate placement with shortened endotracheal tubes.

Supplied sterile in peel-open packages. Intended for one-time use.

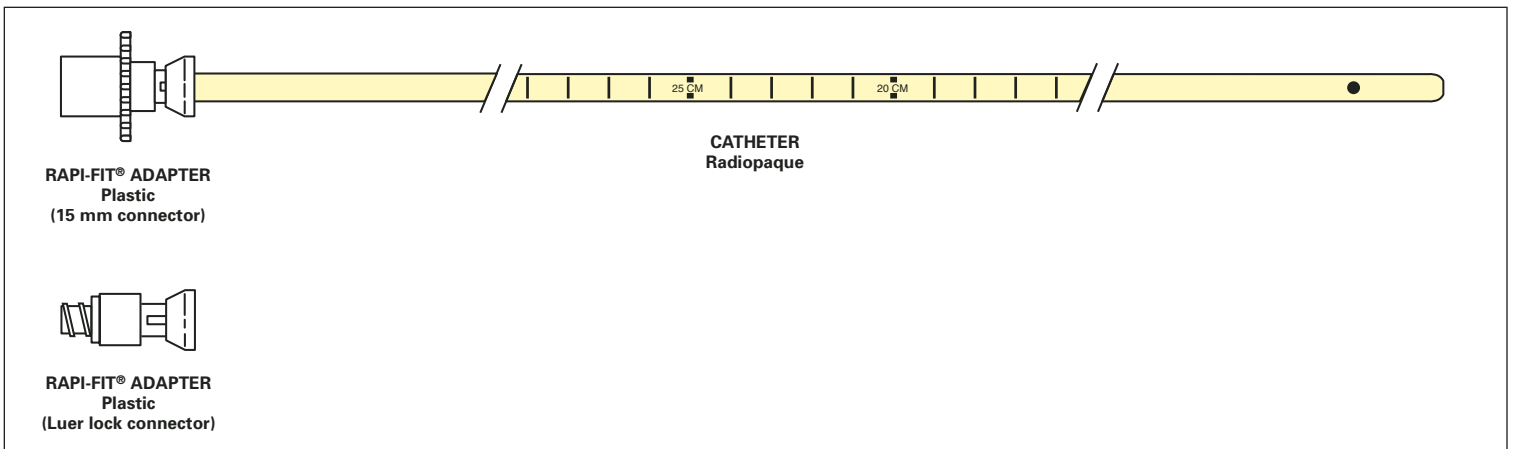

**ORDER NUMBER**

**French Size**

**Length**

**Inner Diameter**

**Use in Replacement of Endotracheal Tube with Inner Diameter**

**Global Product Number**

### For Use With Single Lumen Endotracheal Tubes

ORDER NUMBER	French Size	Length	Inner Diameter	Use in Replacement of Endotracheal Tube with Inner Diameter	Global Product Number
<b>C-CAE-8.0-45</b>	8.0	45 cm	1.6 mm	3 mm or larger	<b>G07833</b>
<b>C-CAE-11.0-83</b>	11.0	83 cm	2.3 mm	4 mm or larger	<b>G06732</b>
<b>C-CAE-14.0-83</b>	14.0	83 cm	3 mm	5 mm or larger	<b>G07873</b>
<b>C-CAE-19.0-83</b>	19.0	83 cm	3.4 mm	7 mm or larger	<b>G05880</b>

Patent Number 5,052,386

## COOK AIRWAY EXCHANGE CATHETERS EF

### EXTRA FIRM

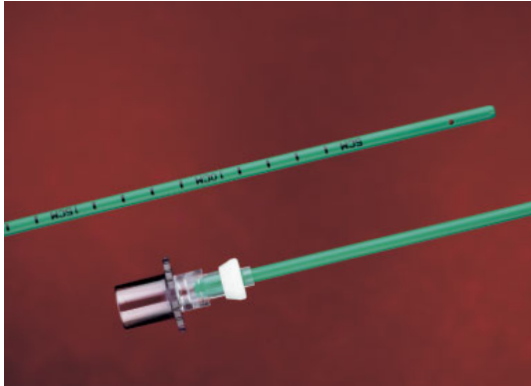

Used for uncomplicated, atraumatic endotracheal tube exchange.

- Extra firm catheter facilitates exchange of double lumen tubes.
- Use of removable Rapi-Fit® Adapter permits use of ventilatory device if necessary during exchange procedure.
- Through-lumen design of catheter with distal sideports ensures adequate air flow.
- Blunt tip of catheter is atraumatic to internal structures.
- Centimeter marks facilitate accurate placement with shortened endotracheal tubes.

Supplied sterile in peel-open packages. Intended for one-time use.

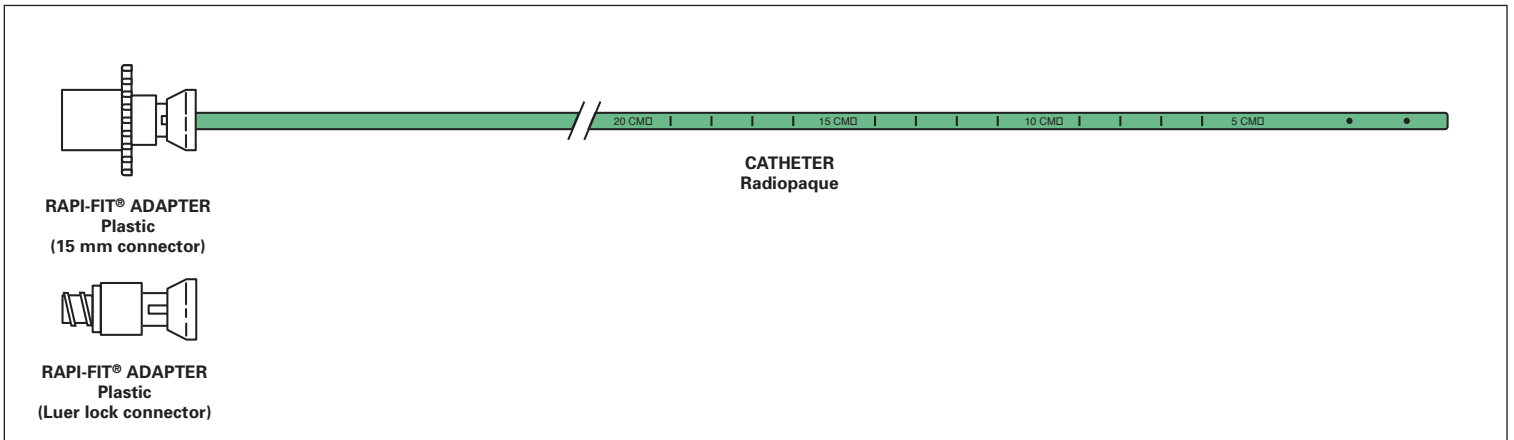

**ORDER NUMBER**

**French Size**

**Length**

**Inner Diameter**

**Use in Replacement of Endotracheal Tube with Inner Diameter**

**Global Product Number**

**For Use With Double Lumen Endotracheal Tubes**

<b>C-CAE-11.0-100-DLT-EF</b>	11.0	100 cm	2.3 mm	4 mm or larger	<b>G13348</b>
<b>C-CAE-14.0-100-DLT-EF</b>	14.0	100 cm	3 mm	5 mm or larger	<b>G13349</b>

Patent Number 5,052,386

## AINTREE INTUBATION CATHETER



Used for uncomplicated, atraumatic endotracheal tube exchange.

- Use of removable Rapi-Fit® Adapter permits use of ventilatory device if necessary during exchange procedure.
- Catheter has larger 4.7 mm lumen.
- Through-lumen design of catheter with distal sideports ensures adequate air flow.
- Blunt tip of catheter is atraumatic to internal structures.
- Centimeter marks facilitate accurate placement with shortened endotracheal tubes.

Supplied sterile in peel-open packages. Intended for one-time use.

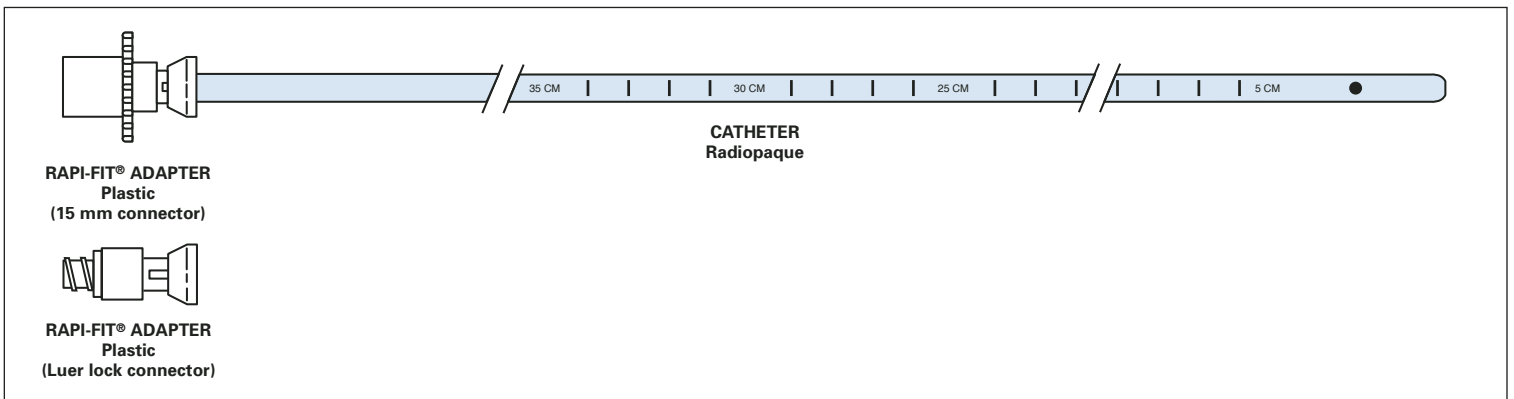

ORDER NUMBER	French Size	Length	Inner Diameter	Use in Replacement of Endotracheal Tube with Inner Diameter	Global Product Number
<b>C-CAE-19.0-56-AIC</b>	19.0	56 cm	4.7 mm	7 mm or larger	<b>G10789</b>

Patent Number 5,052,386

## FROVA INTUBATING INTRODUCERS



Used to facilitate endotracheal intubation and to allow simple endotracheal tube exchange. Use of removable Rapi-Fit® Adapter permits use of ventilatory device if necessary during exchange procedure. Supplied sterile in peel-open packages. Intended for one-time use.

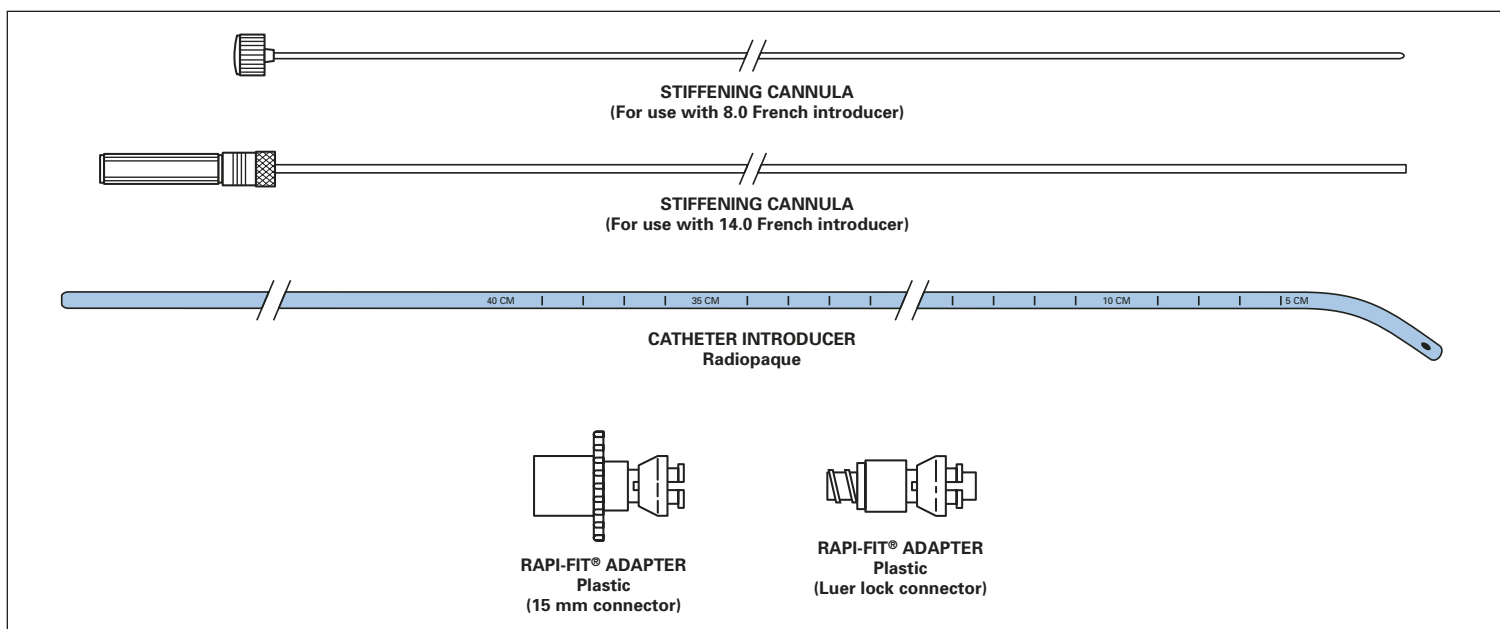

ORDER NUMBER	CATHETER			Use in Replacement of Endotracheal Tube with Inner Diameter <sup>1</sup>	Global Product Number
	French Size	Length	Inner Diameter		
<b>With Stiffening Cannula</b>					
C-CAE-8.0-35-FII	8.0	35 cm	1.6 mm	3 mm or larger	G12591
C-CAE-14.0-65-FII	14.0	65 cm	3 mm	6 mm or larger	G11915
<b>Without Stiffening Cannula</b>					
C-CAE-14.0-65-FI	14.0	65 cm	3 mm	6 mm or larger	G13307

<sup>1</sup>Endotracheal tube not included.

Patent Number 5,052,386



## ENK FIBEROPTIC ATOMIZER SET

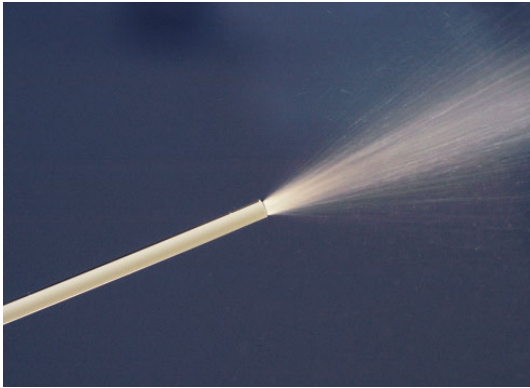

Used for atomizing local anesthetics in connection with flexible fiberoptic intubation techniques. The Enk Fiberoptic Atomizer Set provides adequate topical anesthesia by atomizing small doses of local anesthetics through the working channel of the bronchoscope using flow oxygen.

- Reduced doses of anesthetics together with the atomizer effect enhance patient comfort.
- Repeated administration of local anesthetic solutions and flow oxygen ("spray as you go") keeps the front lens clear during bronchoscope advancement.

Supplied sterile in peel-open packages. Intended for one-time use.

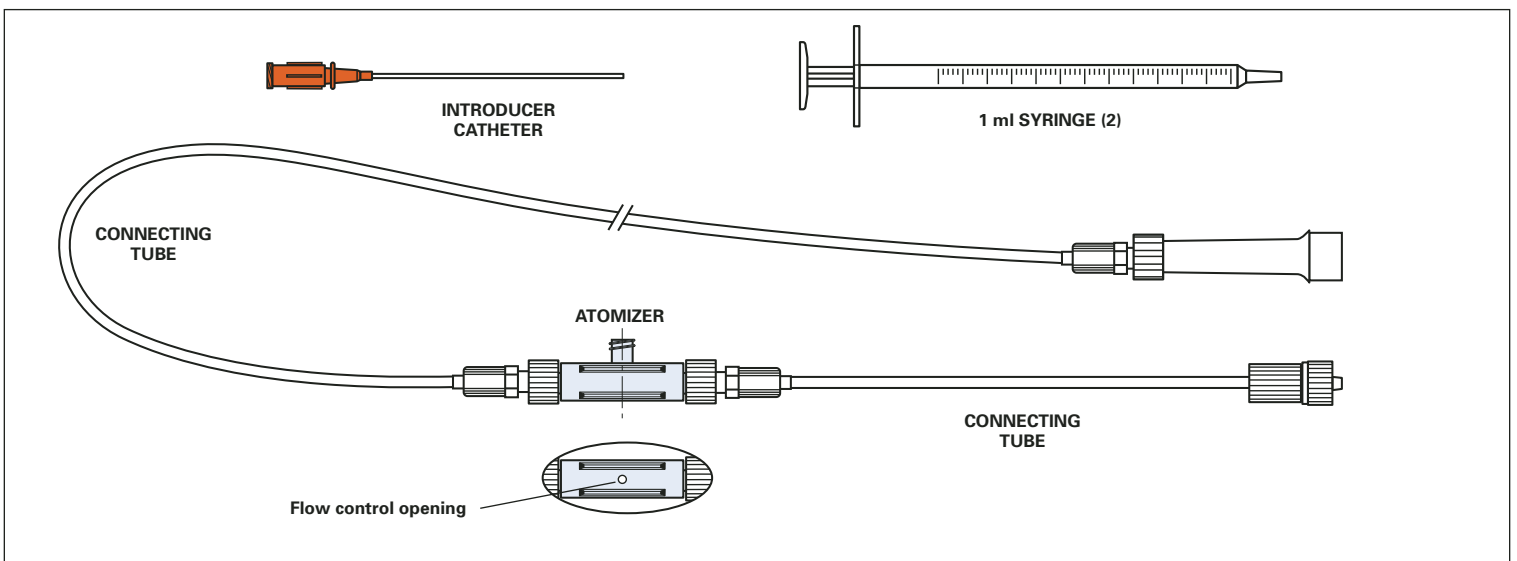

**SET  
ORDER  
NUMBER**

**C-EFNS-100**

**Global  
Product  
Number**

**G27286**

## MANAGEMENT OF THE DIFFICULT AIRWAY CD-ROM

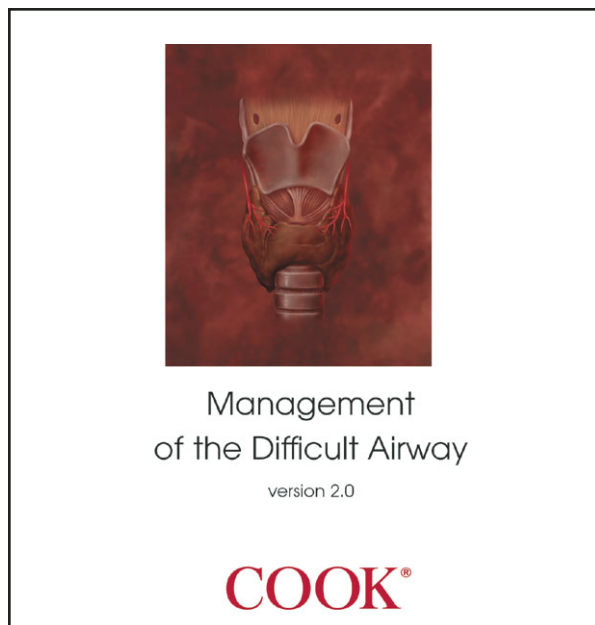

### Objectives:

- A practical and concise introduction to management of the difficult airway.

### Topics Include:

- An interactive tutorial computer program with text, diagrams, pictures and video.
- Planning and recognition of many potential problems.
- Many routine/emergency management techniques.

### Minimum System Requirements:

- 16MB RAM
- 640 x 480 pixel color display with 256 colors
- Sound card and speakers
- CD-ROM drive
- Microsoft Windows 95; Apple system 7.5 or higher
- Quicktime v2.5 or higher

**ORDER  
NUMBER**

C-CD-AIRWAY-1

**Global  
Product  
Number**

G09848

## FUNDAMENTALS OF AIRWAY MANAGEMENT TECHNIQUES

A COLOR ATLAS (A TWO VOLUME SET) BY VIJAYALAKSHI U. PATIL, M.D.

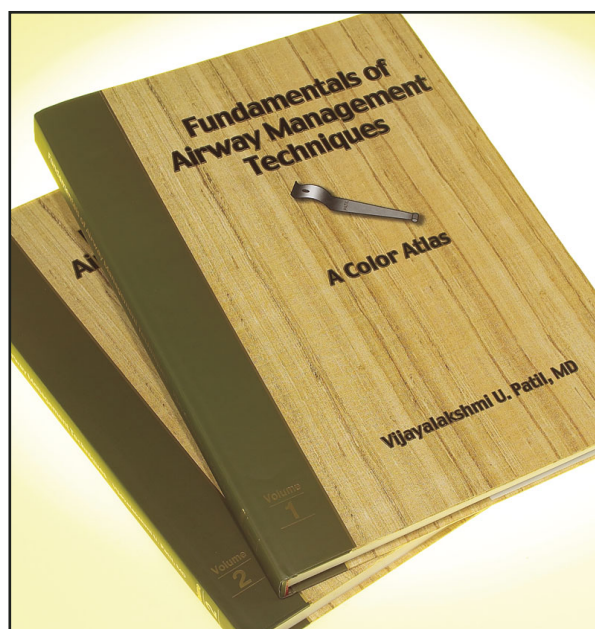

### Objectives:

- The atlas is comprehensive in discussing the basic approach to airway management.
- The volumes describe how to perform each technique in detail and offers solutions to clinical problems and emergencies.

### About Dr. Patil:

- Dr. Patil is the recipient of numerous awards for exhibits on airway management equipment, techniques and teaching models at national and international conferences.

### Ordering Information:

- To order this book please visit the following website: [www.lotuspublications.com](http://www.lotuspublications.com).

## USE OF RAPI-FIT® ADAPTER<sup>1</sup>

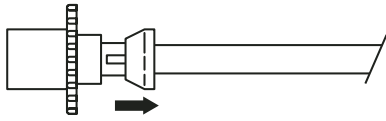

### TO ATTACH

Position on catheter and push white collar forward and lock into position.

<sup>1</sup>For use of Rapi-Fit® Adapter with 15 mm connector or Rapi-Fit® Adapter with Luer lock connector.

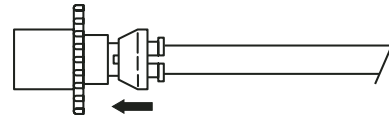

### TO REMOVE

Pull white collar back to release and remove from catheter.

## REFERENCES

P. Safar, J. Penninckx: "Cricothyroid Membrane Puncture with Special Cannula," *Anesthesiology*, 28 (1967), 943-948.

G. Frova: "Comparison Between Two Choices in Grade III Laryngoscopic View Difficulty," *British Journal of Anaesthesia*, 76 (1996), 54.

J. L. Parmet, S. Metz, A. J. Schwartz: "Anesthesiology Issues in General Surgery: Retrograde Endotracheal Intubation: An Underutilized Tool for Management of the Difficult Airway," *Contemporary Surgery*, 49 (1996).

E. P. Loudermilk, M. Hartmannsgruber, D. P. Stolfus, P. B. Langevin: "A Prospective Study of the Safety of Tracheal Extubation Using a Pediatric Airway Exchange Catheter for Patients with a Known Difficult Airway," *Chest*, 111 (1997), 1660-1665.

J. L. Benumof: "Airway Exchange Catheters for Safe Intubation, The Clinical and Scientific Details That Make the Concept Work," *Chest*, 111 (1997), 1483-1486.

G. A. Arndt, J. Topp, J. Hannah, T. S. McDowell, A. Lesko: "Intubation via the LMA Using a Cook Retrograde Intubation Kit," *Canadian Journal of Anaesthesia*, 3 (1998), 257-260.

D. Enk, H. Busse, A. Meissner, H. Van Aken: "A New Device for Oxygenation and Drug Administration by Transtracheal Jet Ventilation," *Anesthesia & Analgesia*, 86 (1998), (2S), S203.

J. D. Tobias: "Intubations Through the Laryngeal Mask Airway Over an Endotracheal Tube Exchange Guide Using End-tidal Carbon Dioxide Monitoring," *The American Journal of Anesthesiology*, November-December, (1997), 308-310.

M. Hawkins, E. O'Sullivan, P. Charters: "Fibreoptic Intubation Using the Cuffed Oropharyngeal Airway and Aintree Intubation Catheter," *Anaesthesia*, 53 (1998), 891-894.

D.P.L. Atherton, E. O'Sullivan, D. Lowe, P. Charters: "A Ventilation-Exchange Bougie for Fiberoptic Intubations With the Laryngeal Mask Airway," *Anaesthesia*, 21 (1996), 1123-1126.

## ACKNOWLEDGEMENTS

G. A. Arndt, M.D., Department of Anesthesiology, University of Wisconsin Medical School, Madison, Wisconsin.

R. J. Melker, M.D., Ph.D., Division of Emergency Medicine, Shands Hospital, University of Florida, Gainesville, Florida.

G. Frova, M.D., Department of Anaesthesia and Intensive Care, Spedali Civili, Brescia, Italy.

C. Ward, M.D., Scripps Green Hospital, La Jolla, California.

D. Enk, M.D., University of Münster, Münster, Germany.

## VIDEOTAPES

### C-VC-18 INSERTION OF THE MELKER EMERGENCY CRICOTHYROTOMY CATHETER

AUTHOR: R. Melker, Shands Hospital, University of Florida, Gainesville, Florida.

### C-VC-43 COOK RETROGRADE INTUBATION SETS

AUTHOR: W. Rosenblatt, Yale-New Haven Hospital, Yale University, New Haven, Connecticut.

## CD-ROM

### C-MCD-TCS803 INSERTION OF THE MELKER EMERGENCY CRICOTHYROTOMY CATHETER

AUTHOR: R. Melker, Shands Hospital, University of Florida, Gainesville, Florida.

## SLIDES

Instructional slide series on the use of products for the difficult airway.

Available upon request from Cook Critical Care.

## POSTERS

Cook Airway Exchange Catheters (C-P-CAE998)

Melker Emergency Cricothyrotomy Catheter Sets (C-P-TCCS998)

Cook Retrograde Intubation Sets (C-P-RETRO998)

Seldinger Technique (C-P-ST899)

Available upon request from Cook Critical Care.

# COOK®

Interventional Critical Care Products

[www.cookcriticalcare.com](http://www.cookcriticalcare.com)

**Distributed by:**

**COOK MEDICAL INCORPORATED**

P.O. Box 4195, Bloomington, IN 47402-4195 U.S.A.

Phone: 812 339-2235, Toll Free: 800 457-4500, Toll Free Fax: 800 554-8335

**COOK (CANADA) INC.**

111 Sandiford Drive, Stouffville, Ontario, L4A 7X5 CANADA

Phone: 905 640-7110, Toll Free: 800 668-0300

**WILLIAM A. COOK AUSTRALIA PTY. LTD.**

Brisbane Technology Park, 12 Electronics Street, Eight Mile Plains

Brisbane, QLD 4113 AUSTRALIA, Phone: +61 7 38 41 11 88

**WILLIAM COOK EUROPE ApS**

Sandet 6, DK-4632, Bjaeverskov, DENMARK, Phone: +45 56 86 86 86

© COOK INCORPORATED 2005

C-DAB705