

SUPERIOR FAS SINGLE LUMEN FLUSH

CONFIGURE YOUR OWN CUSTOM-MADE SUPERIOR FOLLICLE ASPIRATION SET IN 7 STEPS

COPY OR DOWNLOAD THIS CONFIGURATOR AT WWW.GYNETICS.BE,
COMPLETE AND RETURN FOR INQUIRY TO RECEIVE YOUR CUSTOMIZED ORDER NUMBER

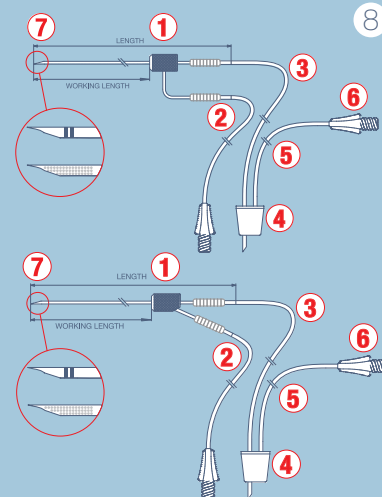

STEP 1 CHOOSE YOUR NEEDLE AND HANDLE

TICK BOX ☒

Gauge	OD/ID (mm)	OD/ID (inch)	Length (mm)	Length (inch)	Control	
17G	1.40/1.20	0.055/0.047	352	13.858	Flexible	<input type="checkbox"/>
17G	1.40/1.00	0.055/0.039	352	13.858	Rigid	<input type="checkbox"/>

The working length of each needle is 300 mm/11.811 inch

U shaped handle  ☐

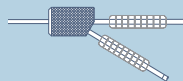
Y shaped handle  ☐

STEP 2 CHOOSE YOUR FLUSH TUBING

Tubing	Length needed	Remarks	
Regular Tubing	<input type="text"/>	cm/inch	n/a <input type="checkbox"/>
Soft Tubing	<input type="text"/>	cm/inch	n/a <input type="checkbox"/>
Thick Wall Tubing	<input type="text"/>	cm/inch	max. 120 cm/47.2 inch <input type="checkbox"/>

STEP 3 CHOOSE YOUR TUBING FROM NEEDLE TO CORK

Tubing	Length needed	Remarks	
Regular Tubing	<input type="text"/>	cm/inch	n/a <input type="checkbox"/>
Soft Tubing	<input type="text"/>	cm/inch	n/a <input type="checkbox"/>
Thick Wall Tubing	<input type="text"/>	cm/inch	max. 120 cm/47.2 inch <input type="checkbox"/>

STEP 4 CHOOSE YOUR SILICONE CORK

Type	Size (mm)	Size (inch)	
Small Cork	14 x 18 x 20	0.55 x 0.71 x 0.79	<input type="checkbox"/>
Medium Cork	21 x 27 x 30	0.83 x 1.06 x 1.18	<input type="checkbox"/>





STEP 5 CHOOSE YOUR TUBING FROM CORK TO PUMP

Type	Length needed	Remarks	
Regular Tubing	<input type="text"/>	cm/inch	n/a <input type="checkbox"/>
Soft Tubing	<input type="text"/>	cm/inch	n/a <input type="checkbox"/>
Thick Wall Tubing	<input type="text"/>	cm/inch	max. 120 cm/47.2 inch <input type="checkbox"/>

STEP 6 CHOOSE YOUR CONNECTION TO THE PUMP

Female Luer Connector (standard)	<input type="checkbox"/>
Male Luer Connector	<input type="checkbox"/>
No Connector	<input type="checkbox"/>

STEP 7 CHOOSE YOUR VARIATION OF THE TIP

Back cut bevel with embossed echogenic marking		<input type="checkbox"/>
Lancet bevel with embossed echogenic marking		<input type="checkbox"/>
Back cut bevel with dual laser echogenic marking		<input type="checkbox"/>
Lancet bevel with dual laser echogenic marking		<input type="checkbox"/>



Gynetics Medical Products n.v.
Rembert Dodoensstraat 51 / 3920 Lommel, Belgium
tel. +32 11 64 58 72 / fax +32 11 64 06 77
info@gynetics.be / www.gynetics.be

GYNETICS[®]
Practise better Medicine